

RAMS-2002 HAND FLANGER

REVISIONS				
ZONE	REV.	DESCRIPTION	DATE	APPROVED
-	-	See Sheet1	-	-

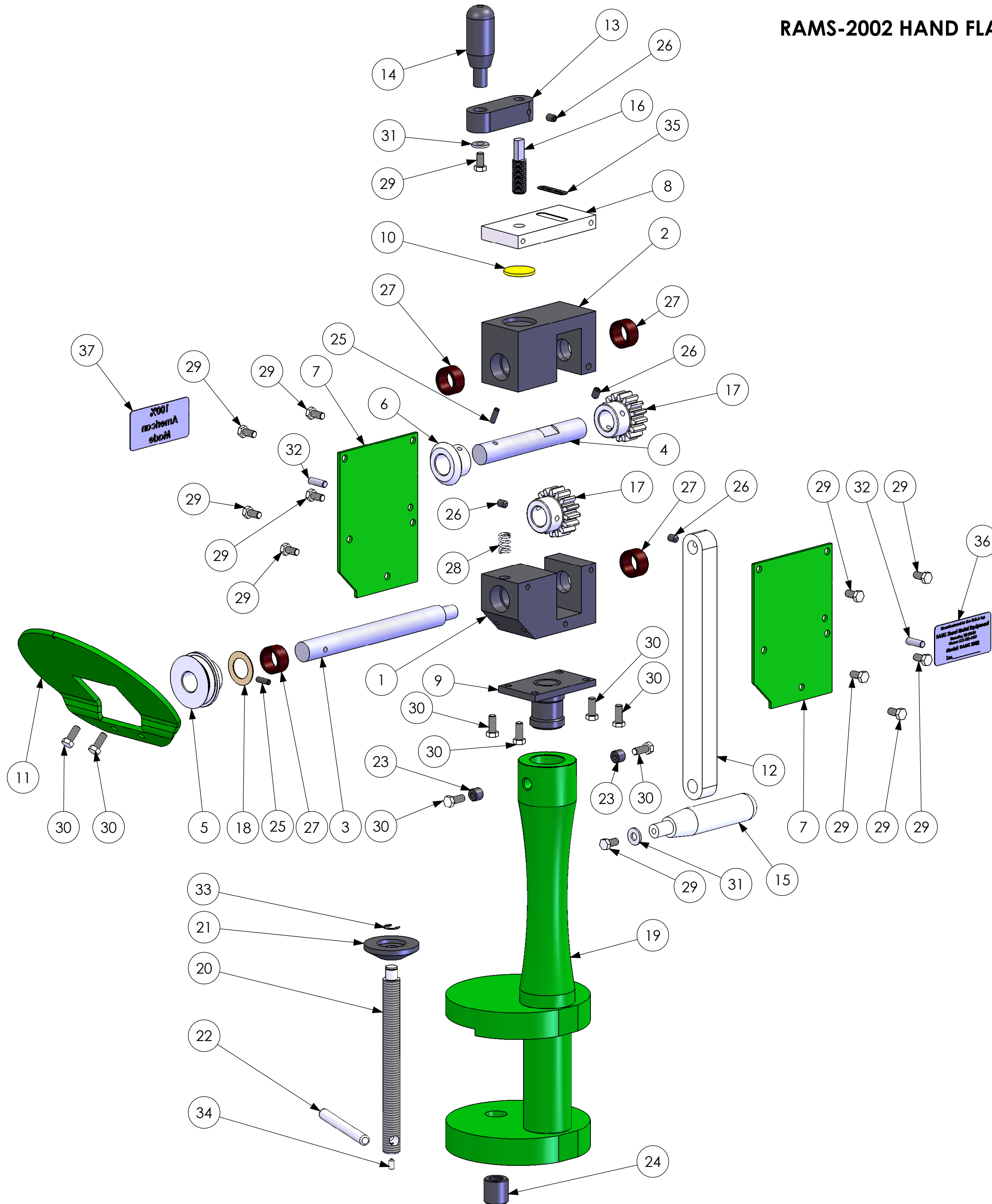

ITEM NO.	PART NUMBER	DESCRIPTION	QTY.
1	HF-1001	LOWER GEAR BLOCK	1
2	HF-1002	UPPER GEAR BLOCK	1
3	HF-1003	DRIVE SHAFT	1
4	HF-1004	IDLER SHAFT	1
5	HF-1005	LOWER ROLLER	1
6	HF-1006	UPPER ROLLER	1
7	HF-1007	SIDE PLATE	2
8	HF-1008	TOP PLATE	1
9	HF-1009	BOTTOM POST ASSEMBLY	1
10	HF-1010	BRASS PUCK	1
11	HF-1011	GUIDE PLATE	1
12	HF-1012	HANDLE ARM (LONG)	1
13	HF-1013	HANDLE ARM (SHORT)	1
14	HF-1014	TOP HANDLE (SHORT)	1
15	HF-1015	TOP HANDLE (LONG)	1
16	HF-1016	1/2-13 THREADED ROD	1
17	CRBE-1019	LOWER SPUR GEAR	2
18	HF-1018	WASHER	1
19	HF-A-2022	CLAMP ASSEMBLY	1
20	HF-1023	CLAMP THREADED ROD	1
21	HF-1024	CLAMP PUCK	1
22	HF-1025	T-HANDLE	1
23	HF-1027	LOCK INSERT: 1/4-20 INTERNAL X 7/16-14 EXTERNAL	2
24	HF-1029	LOCK INSERT 5/8-11 INTERNAL X 7/8-14 EXTERNAL	1
25	HF-1031	3/16" DIA X 9/16" LONG SPRING PIN	2
26	HF-1032	1/4-20 X 3/8" SOCKET SET SCREW	4
27	HF-1035	BEARING: PRT # B-128	4
28	.687 tall spring	SPRING	1
29	HHCS CS .25-20 X .50	HHCS, 1/4-20 X 1/2	12
30	HHCS CS .25-20 X .63	HH CAP SCREW, CS 1/4-20 X 5/8	8
31	Flat Washer - Zinc	1/4" x 5/8" OD Flat Washer, Zinc Plated	2
32	DOWELPIN .25X.75	DOWEL PIN, 1/4" DIA X .75"	2
33	E RING .44	E-RING 7/16" DIA SHAFT	1
34	SSCUPSKT 0.19-32x0.375-HX-N	SOCKET SET SCREW #10-32 X 3/8	1
35	20 GA MAX	LABEL, 20 GA MAX	1
36	RAMS 2002	SERIAL NUMBER TAG	1
37	Made in the USA	LABEL, MADE IN USA	1

DIMENSIONS ARE IN INCHES
TOLERANCES:
FRACTIONAL ± 1/16
ANGULAR: MACH ± BEND ±
TWO PLACE DECIMAL ± .01
THREE PLACE DECIMAL ± .005

DRAWN	JAS	3/15/06
CHECKED	SSL	12/11/08
ENG APPR.		
MFG APPR.		
Q.A.		

HORIZON SYSTEMS MACHINING
9121 58TH PLACE
KENOSHA, WI 53144
PH: 262-605-1122
FAX: 262-605-1198

THE INFORMATION CONTAINED IN THIS DRAWING IS THE SOLE PROPERTY OF HORIZON SYSTEMS MACHINING. ANY REPRODUCTION IN PART OR AS A WHOLE WITHOUT THE WRITTEN PERMISSION OF HORIZON SYSTEMS MACHINING IS PROHIBITED.

MATERIAL	TITLE: RAMS-2002 HAND FLANGER	
FINISH	SIZE DWG. NO. C RAMS-2002	REV. F
DO NOT SCALE DRAWING	SCALE: 1:8	SHEET 2 OF 2